

EDUCATION LEADERSHIP CONFERENCE

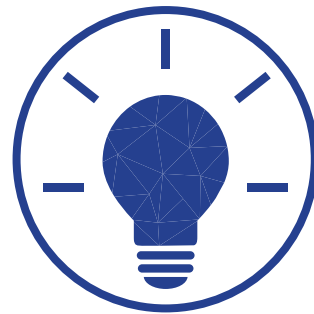

2019

NEVER STANDING STILL: LEADING THROUGH UNCERTAINTY



YALE SCHOOL OF MANAGEMENT

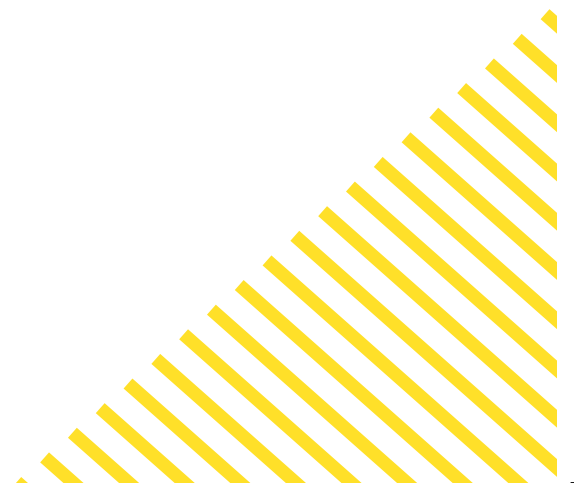

NEVER STANDING STILL: LEADING THROUGH UNCERTAINTY

Dear Educators & Leaders of Change,

Welcome to Yale School of Management's 13th annual student-led Education Leadership Conference. We are thrilled you can join us for the 2019 ELC, Never Standing Still: Leading Through Uncertainty.

Since our first gathering in 2007, the Yale School of Management ELC's mission has been to create a constructive dialogue about how leadership and management skills applied to the education sector can constructively address complex challenges in public education. Through panels, networking, and discussion our speakers, attendees, and partners have created a strong community; we have watched that community grow, and each year new and continued partnerships initiate innovation and sustainable reform toward increased student success and system-wide progress.

For our 13th anniversary, we are excited to host a series of debates, panels, and speakers that will challenge our thinking about the status quo and facilitate solutions-based discussion about how we can continue to move forward in uncertain times. We recognize the necessity to concurrently strive for innovation while also providing stability in our schools. We hope this year's conference will facilitate critical reflection about our progress and inspire all those who are "Leading through Uncertainty".

We are excited to share the knowledge of our panelists, keynote speakers, community advocates, families, and exhibitors. More importantly, we hope that you will share your experiences and connect with fellow leaders in education. Change cannot happen alone, so we are excited you have chosen to join us to explore how we can harness the power of individuals and organizations at every level to affect positive change in education.

Sincerely,

The Yale ELC Team



Prannoy Nambiar
Co-Chair
Content
MBA 2019



Kevin Martinez
Co-Chair
Strategy & Logistics
MBA 2019



Amy Zhu
Co-Chair
Marketing & Sponsorship
MBA 2019

YALE ELC 2019



2ND FLOOR OMNI HOTEL

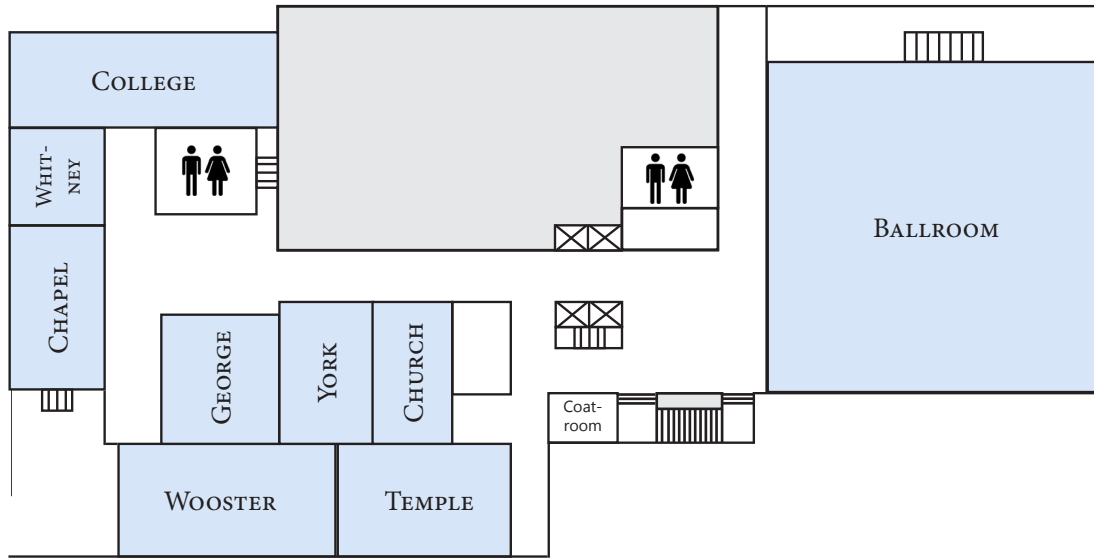

Thursday, April 4, 2019		
5:00pm - 6:30pm	Registration	Lobby (2nd Floor)
6:30pm - 8:00pm	ELC 2019 Opening Plenary: How the Whole-Child Approach is Shifting Instructional and Curricular Practices	Ballroom
8:00pm - 9:30pm	Cocktail Reception	Ballroom
Friday, April 5, 2019		
7:00am - 4:15pm	Registration	Lobby (2nd floor)
7:30am - 8:30am	Breakfast	Ballroom
8:30am - 10:00am	Morning Keynote: Dr. Andres A. Alonso	Ballroom
10:15am - 11:30am	Session I Breakouts The Future of Refugee Education Investing in Education: Criteria for Success Rebuilding School Systems After Natural Disasters Sex Ed in #metoo How to Engage Young People in the Civic Process EY-Parthenon Case Competition	Temple Church York Wooster College Chapel
11:30am - 1:00pm	Lunch	Ballroom
12:00pm - 1:00pm	Afternoon Keynote: Secretary Julia Keleher	Ballroom
1:15pm - 2:30pm	Session II Breakouts Promise and Perils of Data Use in Schools Desegregating Schools: 65 Years Later (Unified Enrollment Systems) Tales of Turnaround Systems of Oppression in Education Reform EY-Parthenon Case Competition	Wooster College York Temple Chapel
2:45pm - 4:00pm	Session III Breakouts The Future of Affirmative Action in the United States - A Debate Promise Neighborhoods at 10 Years Old Schools 2.0 Teacher Quality: What We Know and What We Need to Know EY-Parthenon Case Competition	College York Wooster Temple Chapel
4:15pm - 5:30pm	Closing Keynote: Elisa Villanueva Beard	Ballroom
5:30pm - 6:30pm	Closing Reception	Ballroom

THANK YOU TO OUR GENEROUS 2019 SPONSORS

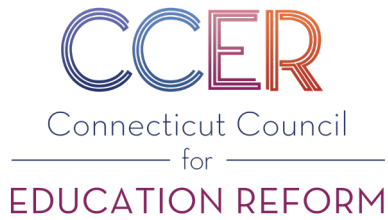

YALE ELC 2019

Y

SPECIAL THANKS TO OUR TEAM AND ADVISORS

ELC Content Team

Prannoy Nambiar, '19
Sidney Scott, '20
Adam Hogue, '20
Ryo Moriyasu '19
Natalie Eller '20
Michael Magdzik '20
Nate Schorr '20
Alberto Munoz '20
Jenny Palacios '20
Betty Tang '20
Jasmine Ako '19
Robert Lin '19

ELC Marketing & Sponsorship

Amy Zhu, '19
Arielle Sydnor, '20

ELC Logistics Team

Kevin Martinez, '19
Anna Collura, '20

Yale SOM ELC Advisors

Jen Alexander
Ken Paul
Mira Debs
Tara Anderson
Matt Bosch
Jeanie Lombardi
Erik Clemons
Jim Liebman
Andy Rotherham
Thomas Toch